

CH# MAP SHOWING THE LAND OF NIJASHREE
USING SCHEME AT L.R. PLOT NO-9694 OF MOUZA-
KALYANI, J.L.NO-58. IN THE THE KALYANI, P.S -

KALYANI, DIST - NADIA

SCALE - 16" = 1 MILE

POSSESSED AREA SHOWN THUS -

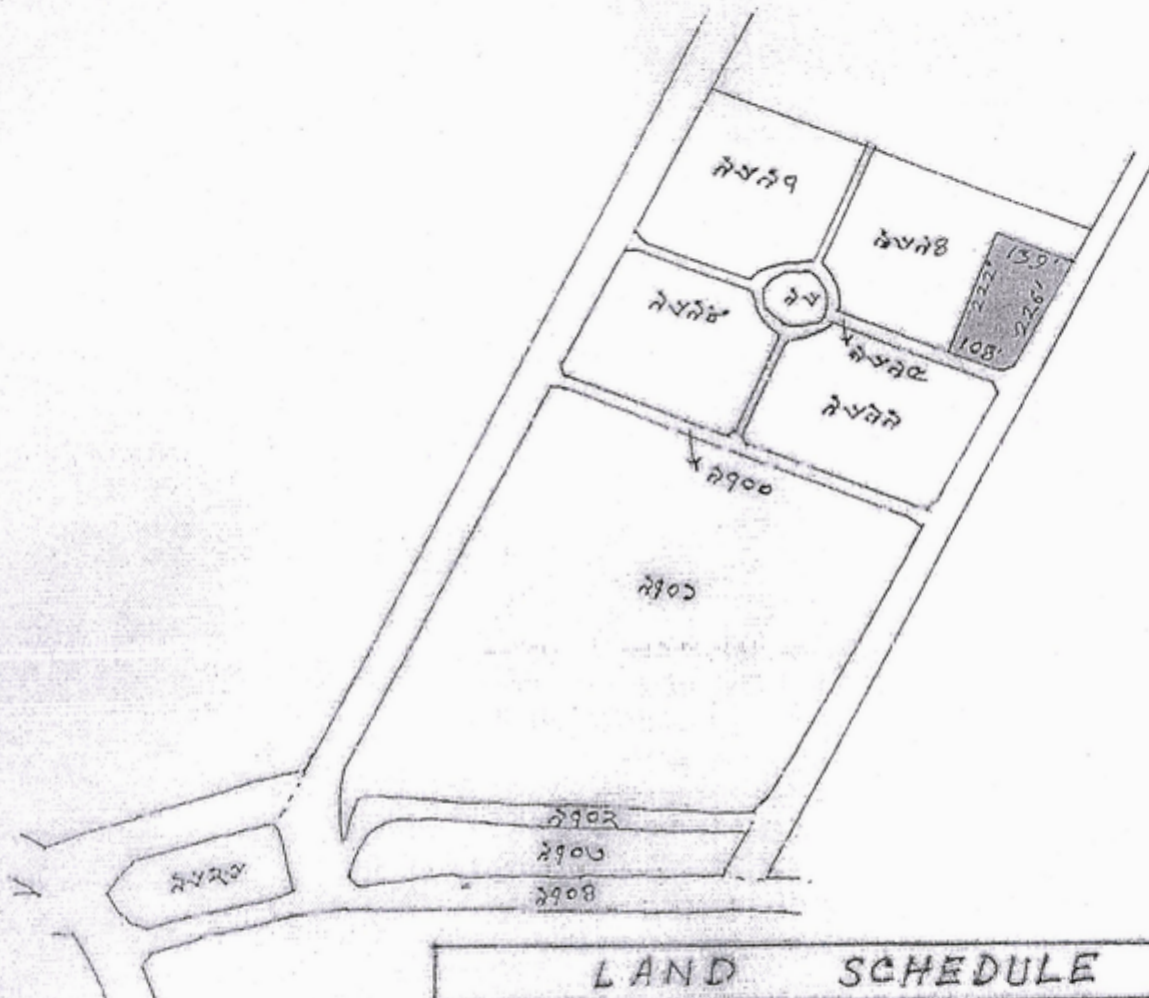

S. K. Saha
 8/8/23

LAND SCHEDULE		
PLOT NO	AREA OF THE PLOT	POSSESSED AREA OF "NIJASHREE"
9694(L.R)	2.35 ACRE	0.635 ACRE

Mamul Mukherjee
 Amin, B.L.S. L.R.O
 Chak Bahar